

HIGHLAND AVENUE

AVENUE

TYPICAL X-SECTION STERLING AVE.
No Scale

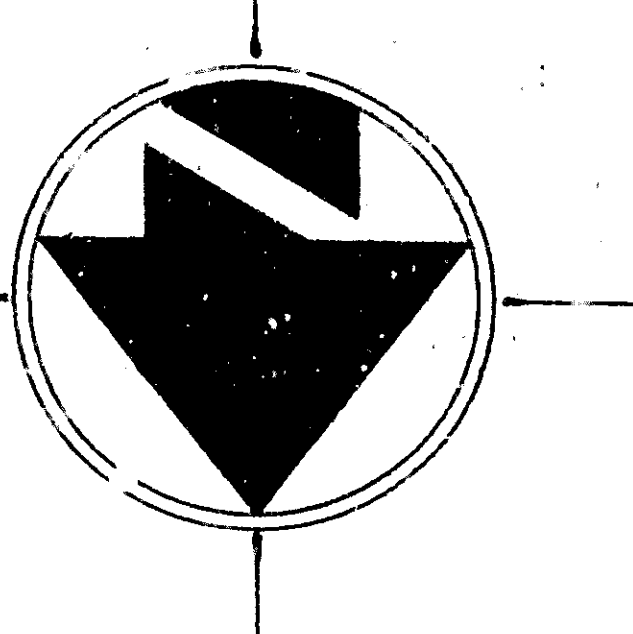
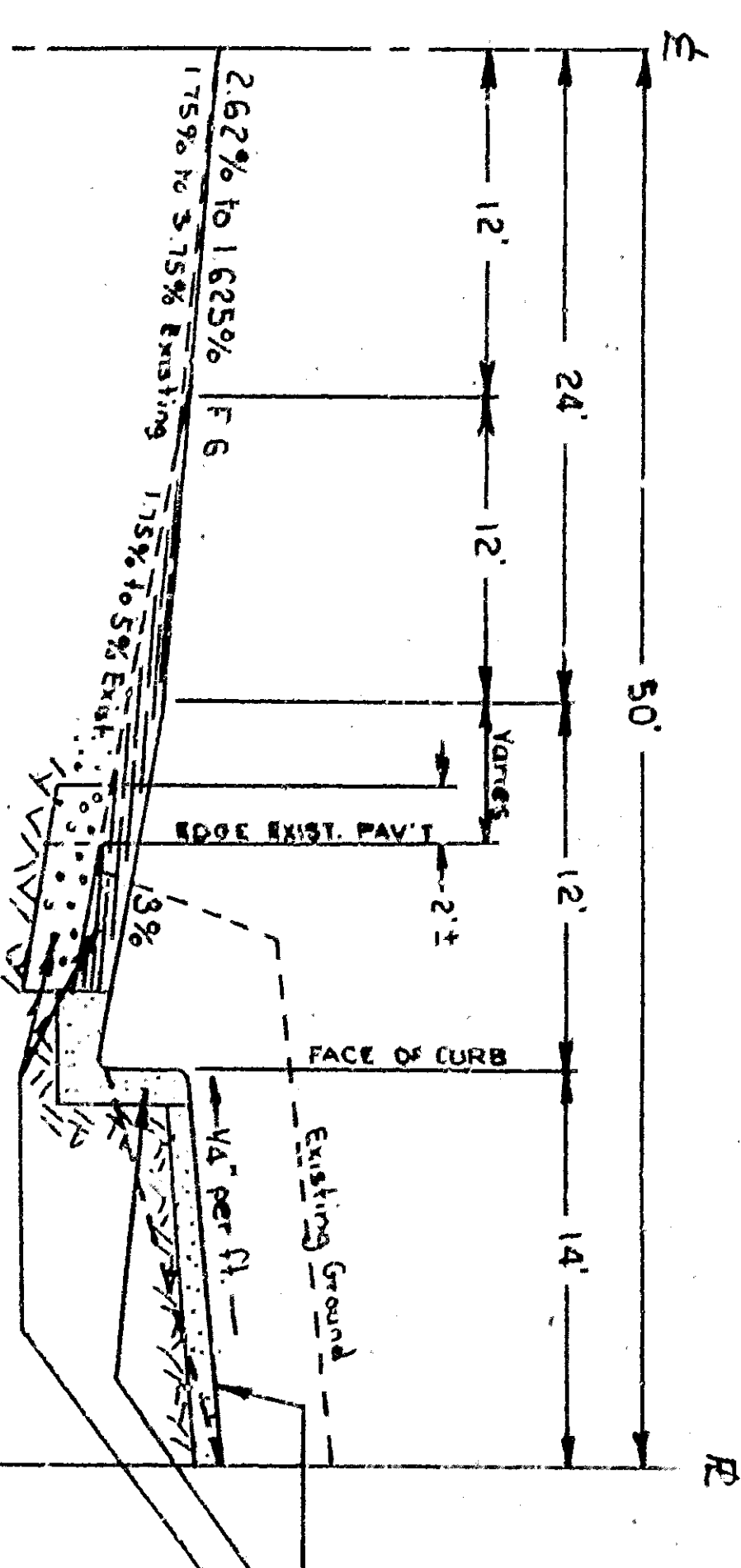

PUMALO ST.

TRACT NO. 4690
MB 58/97

ARGYLE AVE.

DEPARTMENT OF ENGINEERING
CITY OF SAN BERNARDINO
IMPROVEMENT PLAN & PROFILE
STERLING AVENUE

HIGHLAND AVENUE

APPROVED: [Signature]
CITY ENGINEER NO. 2453

DRAWN BY: [Signature]
CHECKED BY: [Signature]

REFERENCE: 1966
DRAWING NO. 3389
SHEET 2 OF 2 SHEETS

DATE: 10/11/66
BY: [Signature]

DATE: 10/11/66
BY: [Signature]

DATE: 10/11/66
BY: [Signature]



HIGHLAND AVENUE

AVENUE

1200-50 FT
1200

0 1 2 3 4 5 6 7 8 9

PROFILE STERLING AVE

STERLING AVENUE

TYPICAL X-SECTION STERLING AVE.
No Scale

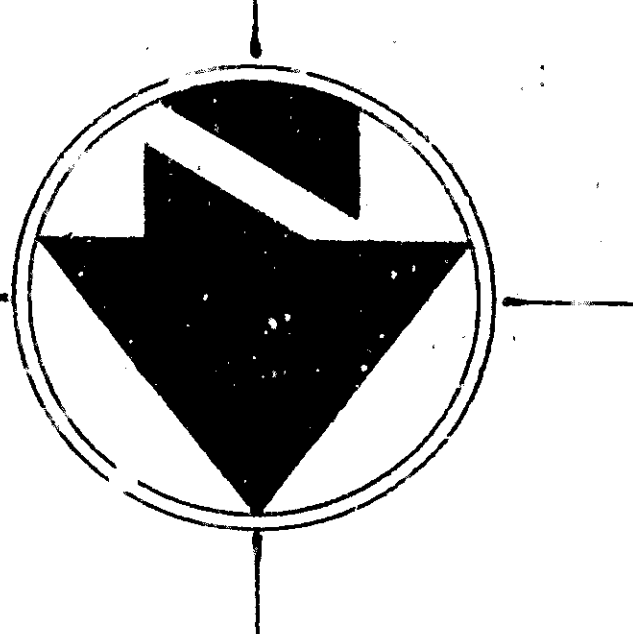
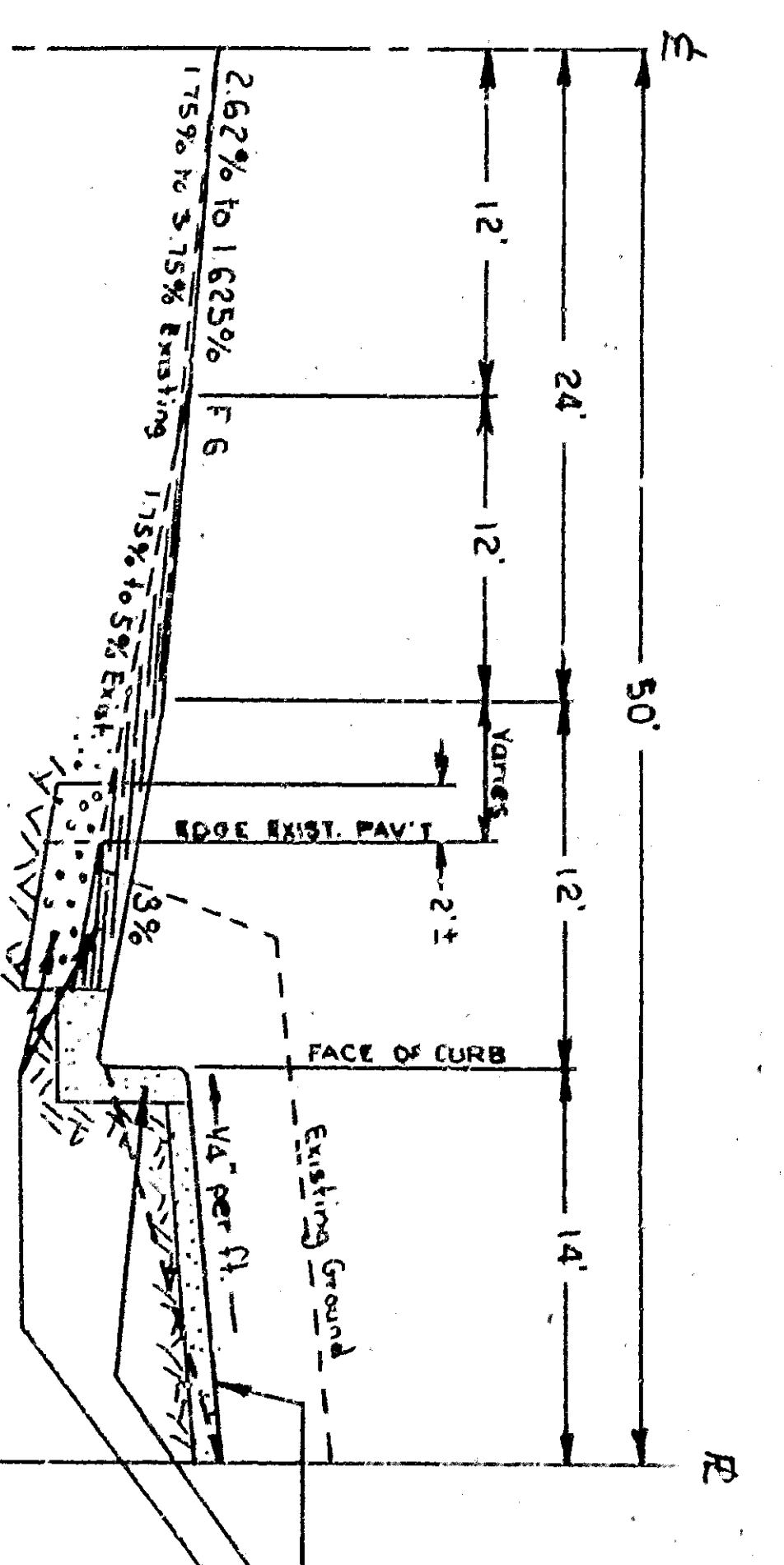

PUMALO ST.

TRACT NO. 4690
MB 58/97

ARGYLE AVE.

DEPARTMENT OF ENGINEERING
CITY OF SAN BERNARDINO
IMPROVEMENT PLAN & PROFILE
STERLING AVENUE

HIGHLAND AVENUE

1966

APPROVED: [Signature]
CITY ENGINEER NO. 2453

DRAWN BY: [Signature]
CHECKED BY: [Signature]

3389
SHEET 2
OF 2 SHEETS

DATE: 10/11/66
BY: [Signature]

DATE: 10/11/66
BY: [Signature]

DATE: 10/11/66
BY: [Signature]